



D.C. Tacho-generators

EG 72.2...
40072200

The d.c. tachogenerators are used as measuring instruments for values dependent on speed and direction of rotation in measurement and control techniques. They convert the speed at which they are driven into a direct voltage proportional to the speed. The polarity of the generated voltage depends on the direction of the driving motor.

The generators may be used in conjunction with moving coil indicators for remote bi-directional analogue measurement.

Technical Data

voltage at zero-load	33 v at 1000 rpm
Rated voltage tolerance	± 6 %
Speed of driving shaft	5000 rpm
Armature resistance	280 ohm (including serial resistor of 220 ohm)
Rated current	20 mA
Max. current	60 mA
Linearity variation	≤ 1.5 %
Direction of rotation	reversible
Reversing error	± 1 %
Superimposed a.c. voltage (eff.)	≤ 6% from 200 to 5000 rpm
Enclosure	EG 72.2-33 IP 65 (DIN 40050) EG 72.2-33 G.. shaft side IP 40 - casing IP 54 (DIN 40050) special design IP 65
Electrical connection	Connection board
Number of slots	540 V ac up to 4 mm ²
Number of laminas	19
Number of poles	38
Weights	2 EG 72.2-33 z = 2.4 kg f = 2.6 kg fl = 2.7 kg EG 72.2-33 G .. z = 2.7 kg f = 2.9 kg fl = 3.0 kg
Starting torque	2.5 Ncm
Carbon brushes	2 pairs carbon brushes, quality AG 35, 5x3x12, guarant operation for about 15,000 hrs at 1500rpm

EG 72.2-33 z

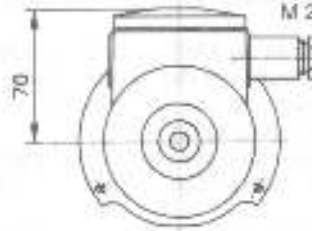
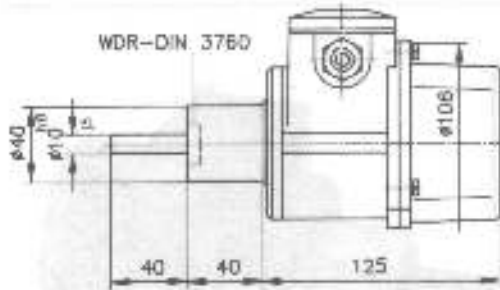

Kabelverschraubung wahlweise
Cable entry either
M 24x1,5; M 18x1,5; Pg7

EG 72.2-33 G.. z

Mit Getriebe 1:3 oder 1:4
With gear 1:3 or 1:4

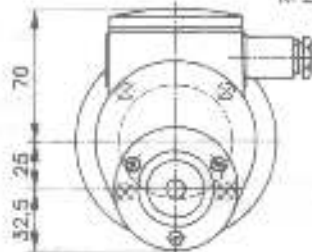
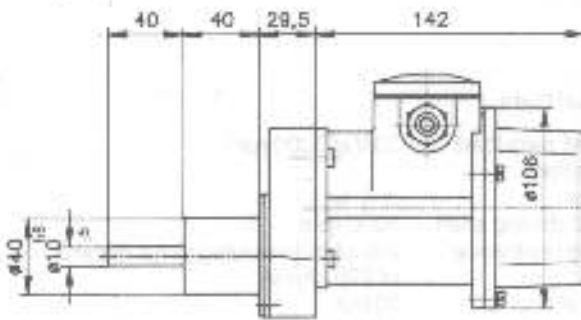

Kabelverschraubung wahlweise
Cable entry either
M 24x1,5; M 18x1,5; Pg7

EG 72.2-... f

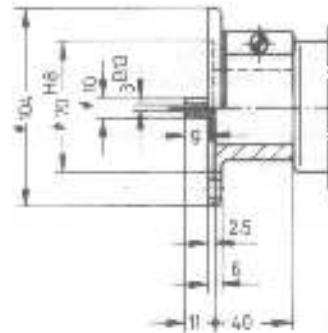
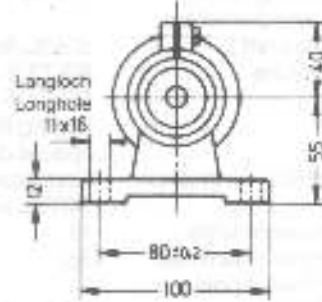
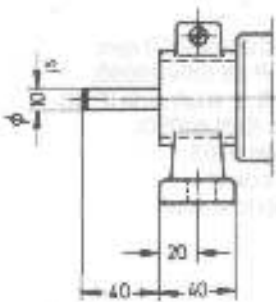

EG 72.2-... fl

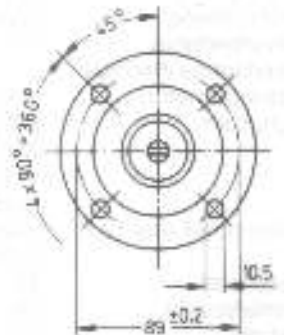

Bestellbezeichnung:
Order designation:

EG 72.2-33 z

EG 72.2-33 G1:4 z

Zapfenausführung
Version with spigot

Getriebe 1:4
Gear