

**EZ 6/...**  
**EZ 7/560...**  
**EZ 056.../35**  
**60800010**

## HORN PULSE COUNTER

### Pulse Counter EZ 6/...

The pulse counter serves in combination with an electrical generator for the remote count of the rotation of a shaft or of any other related physical process. It consists out of an electrical drive and a mechanical figure wheels system. The incoming pulses from the generator are switched by an anchor gear into a mechanical movement of the figure wheels.



### Pulse Difference Counter EZ 7/560...

This counter has two drives for two current circuits, one system is adding the other subtracting. This counter mechanism shows automatically the difference between the incoming pulses of the addition and the subtraction. These pulses can arrive at the same time or time shifted, in this case the count is also exact and reliable.

#### Technical Data EZ 6/...

Method of working	Electromechanical counter, adding
Method of counting	1 pulse = 1 figure
Count time	10 pulses/sec
Pulse voltage	24V or 220 V $\pm 10\%$
Time of switch on	100 %
Display	7 mm high, white on blackground, 7 digits, during the zero reset no incoming pulses are allowed.
Mounting	2 clamping springs or fixing holes in the front plate
Colour	Front plate black dull
Weight	About 0.7 kg.

#### Technical Data EZ 7/...

Electromechanical counter, making differential
1 pulse adding = 1 figure adding
1 pulse subtracting = 1 figure subtracting
10 pulses/ sec
24 V or 220 V $\pm 10\%$
100 %
5 digits, about 5 mm high, white on black back ground, during the zero reset no incoming pulses are allowed.
2 clamping springs.
Front plate stone grey.
About 0.18 kg

### Pulse Counter EZ 056.../35

The counter has in its housing according DIN 43700 an electronic amplifier connection and an electro mechanical counter. It is specially designed for tor the remote count of shaft rotation, because it can be directly connected to the signal voltage of an AC tacho generator and the result of the count cannot be deleted in case of a break-down of the auxiliary power supply. This unit is extremely noiseless.



#### Technical Data EZ 056.../35

Display	8 digits, 4.5 mm high figures
Counting time	Max. 20 pulses per second
Electrical zero setting	No
Weight	About 0.8 kg
Input	

#### Technical Data EZ 0565 .../35

5 digits, 4.5 mm high figures
Max. 20 pulses per second
Voltage 24V= $\pm 10\%$ / 22 W pr 110/220 V / 30 VA
Pulse for zero setting min. 250 ms/max. 60 sec during the zero reset no incoming pulses are allowed.
About 1.0 kg.
For the connection to AC tacho generator, galvanic isolation from auxiliary voltage: type EZ 056.0 transformer coupling max. 0.6 V/Hz in the range 0.6 V <sub>eff</sub> to 60 V <sub>eff</sub> ;
For connection to sensor:
Type EZ 056.3 input according Namur (from 0 Hz)
For connection to rotary encoder:
Type EX 056.4 input positive pulses > 12 V
Input frequency/count frequency 1:1 up to 999:1, programmable ex works.
220V / 110V / 50 - 60 Hz $\pm 15\%$ or
24 V = $\pm 20\%$ / approx. 70 mA

Divider

Auxiliary voltage

**Dimensions**

connection sketch  
count input  
zero setting (if any)  
auxiliary voltate

**Other designation**

Screw fixing

clamping spring fixing

method of zero setting

EZ 6/218.70  
EZ 6/218.75  
EZ 6/218.74

EZ 6/228.70  
EZ 6/228.75  
EZ 6/228.74

without  
manual with button  
manually lockable with button

EZ 6/219.77  
EZ 6/219.74

EZ 6/229.77  
EZ 6/229.74

only electrically  
electrically and manually lockable

**Maße**

EZ 6/218 ...  
EZ 6/219 ...

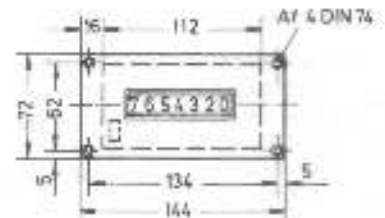
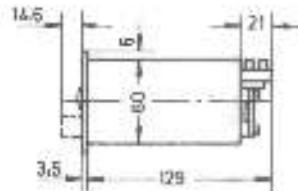

EZ 6/228 ...  
EZ 6/229 ...

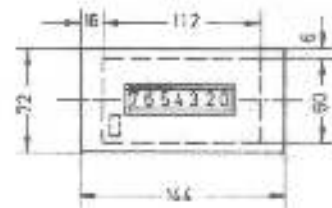
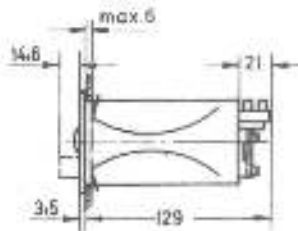

EZ 7/560 ...

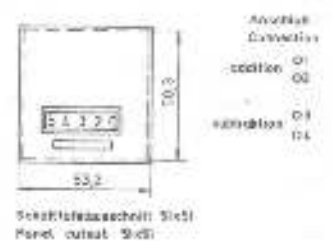
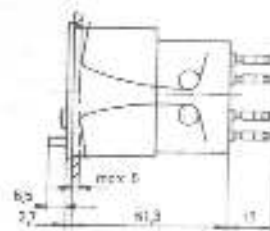

EZ 056.../35

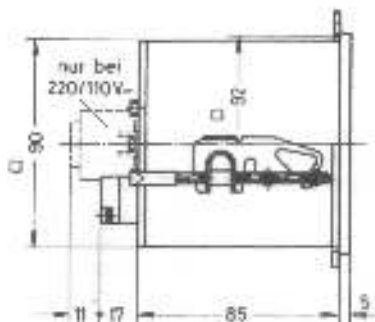
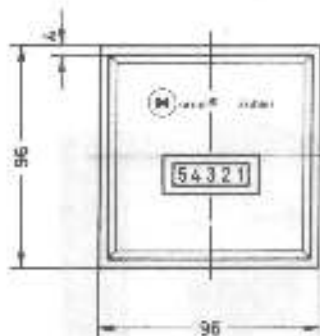

**Anschlußbild**

